

# Score-TRICENTRIC®

## Metal Seated High Performance Butterfly Valves

Class 300 - Sizes 30" - 42"

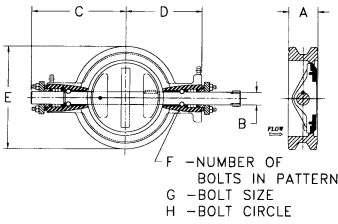

**WAFER**

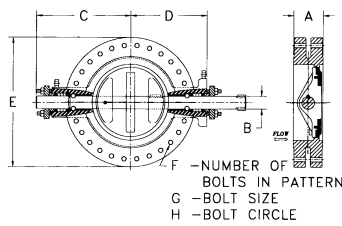

**LUGGED**

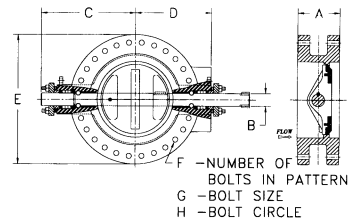

**DOUBLE FLANGE**

### DIMENSIONS

Valve Size	Style	A in.	B in.	C in.	D in.	ASME B16.47 Series A					ASME B16.47 Series B					Cv	
						E in.	F no.	G size.	H in.	Approximate Weight lbs.	E in.	F no.	G size.	H in.	Approximate Weight lbs.		
30	Wafer	10	4	29 <sup>13</sup> / <sub>16</sub>	24 <sup>13</sup> / <sub>16</sub>	33 <sup>3</sup> / <sub>4</sub>	28	1 <sup>3</sup> / <sub>4</sub>	39 <sup>1</sup> / <sub>4</sub>	1800	33 <sup>3</sup> / <sub>4</sub>	36	1 <sup>3</sup> / <sub>8</sub>	36 <sup>1</sup> / <sub>4</sub>	*	29,600	
	Lugged					43				2950	39				*		
	Double Flange	12 <sup>1</sup> / <sub>2</sub>				43				3150	39				*		
36	Wafer	12	5	35 <sup>7</sup> / <sub>16</sub>	29 <sup>7</sup> / <sub>16</sub>	40 <sup>1</sup> / <sub>4</sub>	32	2	46	3150	39 <sup>3</sup> / <sub>4</sub>	32	1 <sup>5</sup> / <sub>8</sub>	42 <sup>7</sup> / <sub>8</sub>	*	42,700	
	Lugged					50				4750	46 <sup>1</sup> / <sub>8</sub>				*		
	Double Flange	13				50				4900	46 <sup>1</sup> / <sub>8</sub>				*		
42	Wafer	12 <sup>3</sup> / <sub>4</sub>	5	37 <sup>13</sup> / <sub>16</sub>	31 <sup>13</sup> / <sub>16</sub>	44 <sup>3</sup> / <sub>4</sub>	32	1 <sup>5</sup> / <sub>8</sub>	47 <sup>1</sup> / <sub>2</sub>	4150	46	36	1 <sup>3</sup> / <sub>4</sub>	49	*	58,100	
	Lugged					50 <sup>3</sup> / <sub>4</sub>				5350	52 <sup>1</sup> / <sub>2</sub>				*		
	Double Flange	ISO				16 <sup>3</sup> / <sub>16</sub>				50 <sup>3</sup> / <sub>4</sub>	5600				52 <sup>1</sup> / <sub>2</sub>		*
		OPT				14 <sup>3</sup> / <sub>4</sub>											*

ISO = represents ISO 5752 short face-to-face

Opt = represents Manufacturers optional face-to-face

\* Consult Score Energy Products Inc.

Dimensions & Weights subject to change without notice. Consult Score Energy Products for confirmation